

The black of night is an opportunity for the lighting urbanist to design an environment that is enticing, inclusive and which promotes activity and reflection. Illumination's seemingly magic and delightful properties when artfully conceptualized and crafted, provide atavistic and celebratory atmospheres lacking in common city life.

Into darkness the artistry of light proclaims a special power to inspire, play, encourage the best proclivities of our built and commercial environment, perhaps to realize this quote from the special effects master Edgar Allen Poe.



Then we sallied forth into the streets, arm in arm,



or roaming far and wide until a late hour,



seeking amid the wild lights and shadows of the populous city,



that infinity of mental excitement

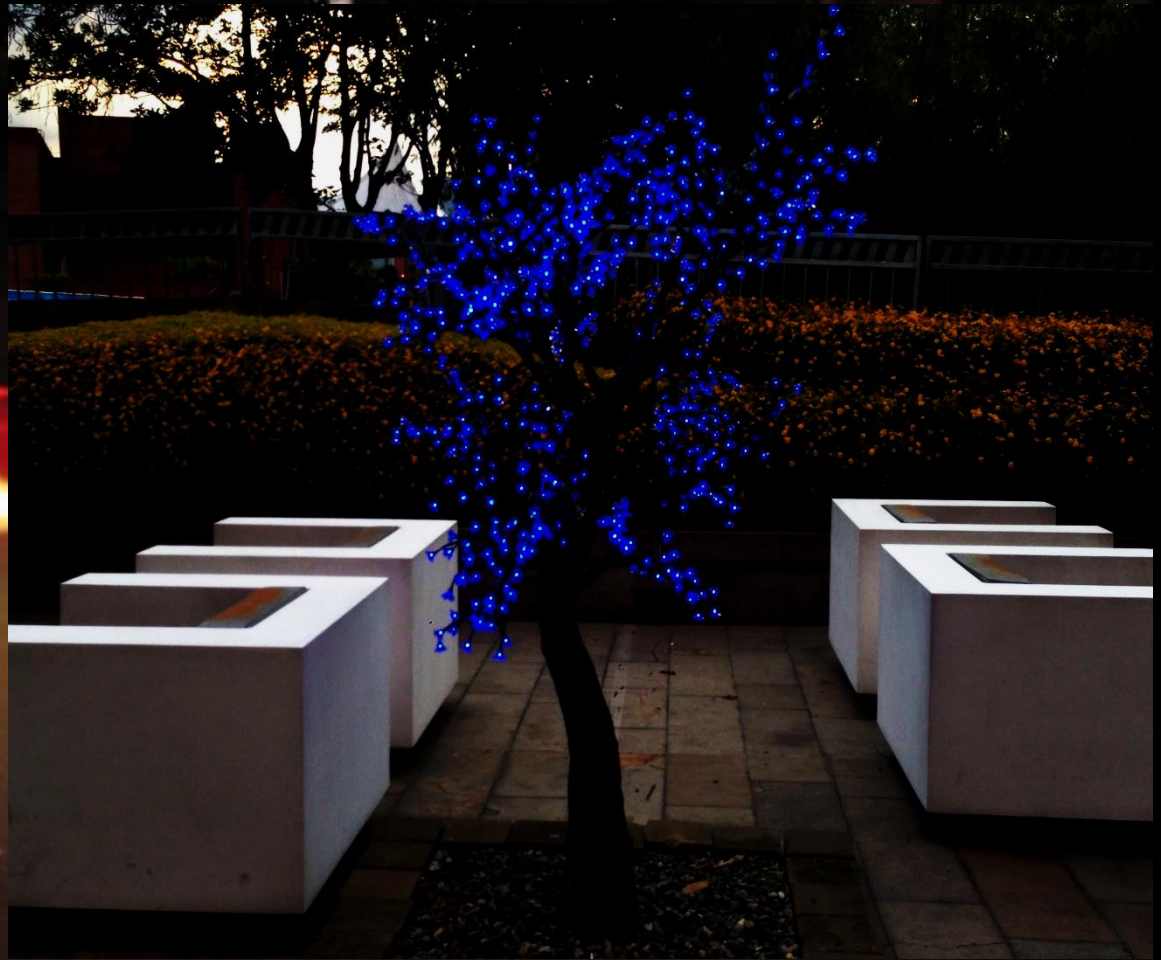

which quiet observation can afford.

Nighttime Design: Best Practice, New Methodologies

An interdisciplinary practice transforming cities into inclusive, beautiful and healthy places to work and play

Nighttime Design Objectives



**Economic
vitality**

**Public
Health**

**Welcome
(safety)**

Markets and Clients to implement Best Practice Lighting

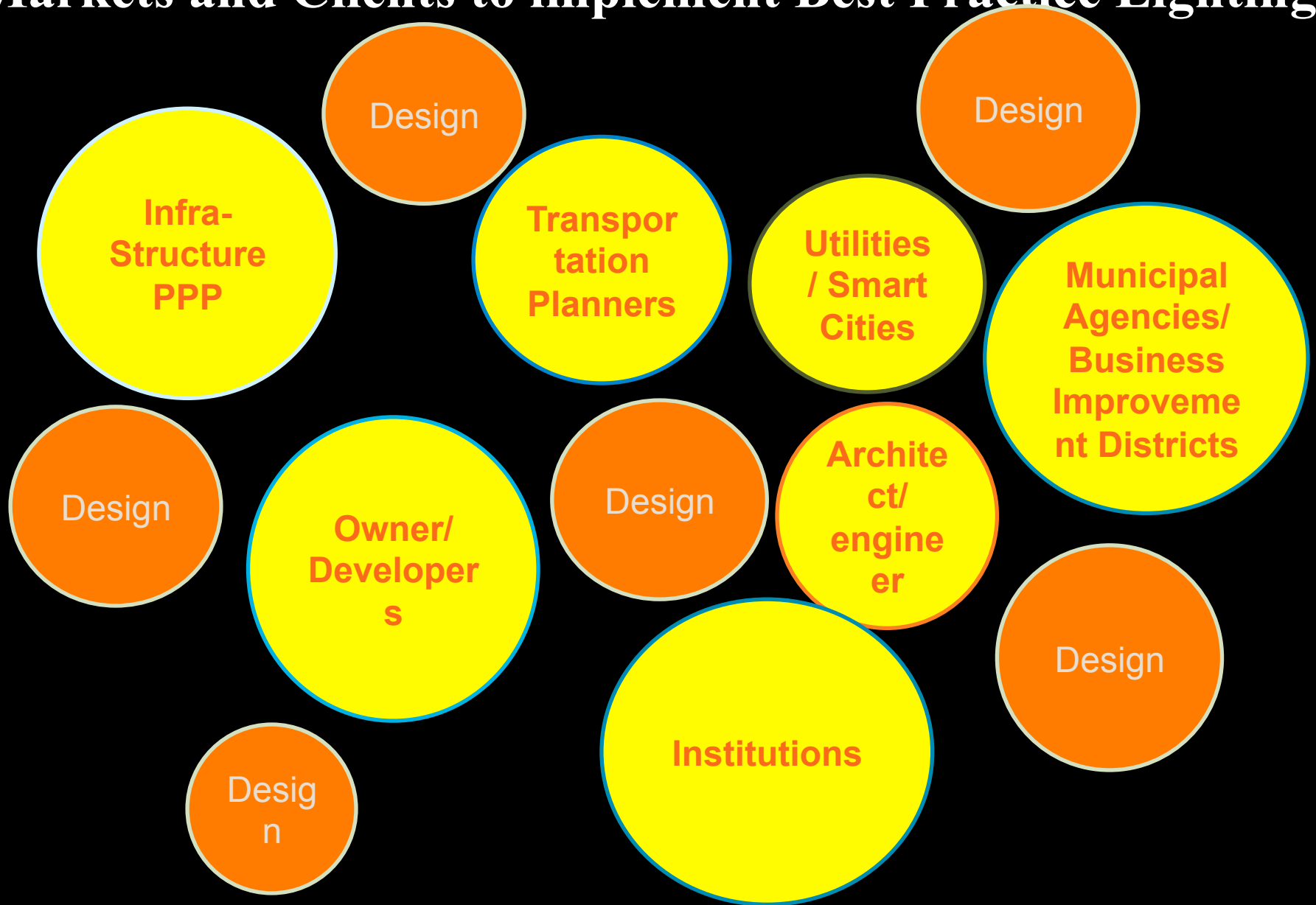

Nighttime Design: Best Practice, New Methodologies

Some examples of illuminated environments that encourage interactions, new understanding of infrastructure and the city

Parking Lot Transformation: Active light



Temporary Artworks: Riverine Interpretation



A Promenade: Experience



A Plaza: Site Specific



The Brutalist Bridge: Information Display

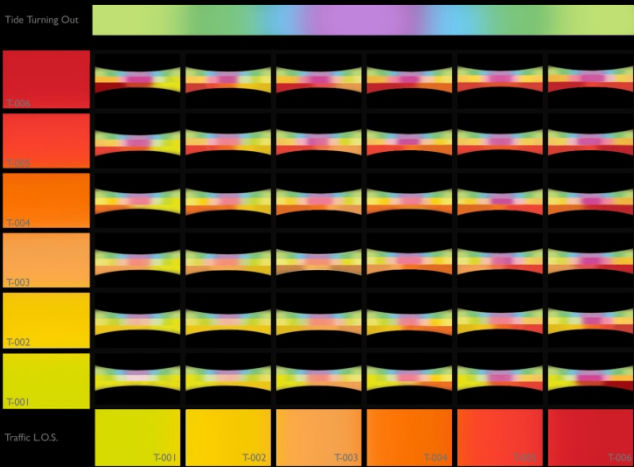

LIGHT
LENI SCHWENDINGER PROJECTS LTD

Kingston Bridge Illumination
Color Mix: Tide Turning Out



Elevated Bus Ramps: Transformed by Light

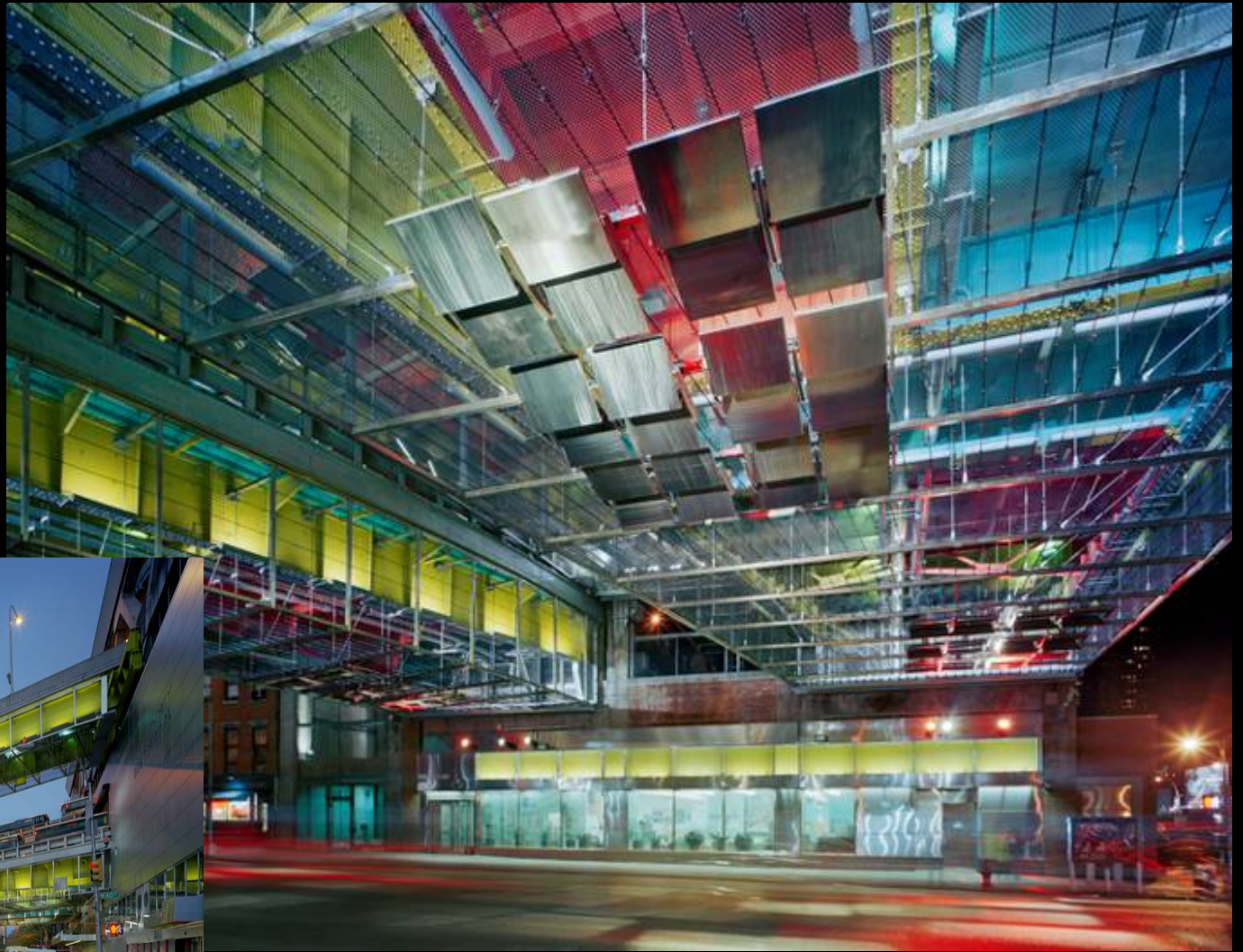

Jackson Heights/ Corona Partnership Lighting Strategy

Roadmap for Illumination, Placemaking and Community-Building

LightTalk

Provides a basic understanding of our cities' lighting systems. Planning professionals will gain insight to the after-dark experience, learning to build on it to create a welcoming public realm. General audiences will gain insight into various kinds of lighting that typify public spaces after-dark.

Community Meetings



LightWalk

Participants will join Leni in decoding the shadows, emanations, and reflections that define the nightscape - from shop silhouettes and signage to streetlights and the phantom photons of passing cars.



LightMap/ Planning Map

Every place is unique. A custom map will be provided for your LightWalk. For urban design and planning workshops, a preliminary light strategy map will be created.



A Roadmap for Illumination and Community-Building

Appendix

Sample Readings 82nd Street (37th Ave - Baxter Ave)

Horizontal illuminance lighting levels at ground level provided by public lighting fixtures

Horizontal illuminance lighting levels at ground level provided by mix of public and private lighting

Observation text on this page:
- Some low pressure sodium lamps were identified by color. Could be a ballast/lamp mismatch or end of life.
- Acorn fixtures unless otherwise noted

FOR REFERENCE	
NYC DOT Street Light Requirements	
Street:	1.1 - 1.6 fc
Sidewalk:	0.5 - 0.9 fc
Residential Road:	0.5 - 0.9 fc
Intersections:	2.2 - 3.3 fc

Sample light readings mean range:	
Street:	0.4 - 0.8 fc
Sidewalk:	0.3 - 3.8 fc
Residential Road:	0.1 - 0.5 fc
Intersections:	0.4 - 0.9 fc

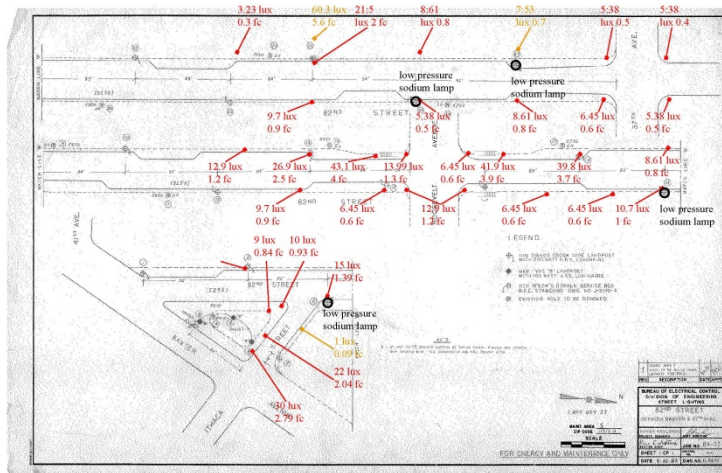

LightMap/ Planning Map

Every place is unique. A custom map will be provided for your LightWalk. For urban design and planning workshops, a preliminary lightstrategy map will be created.



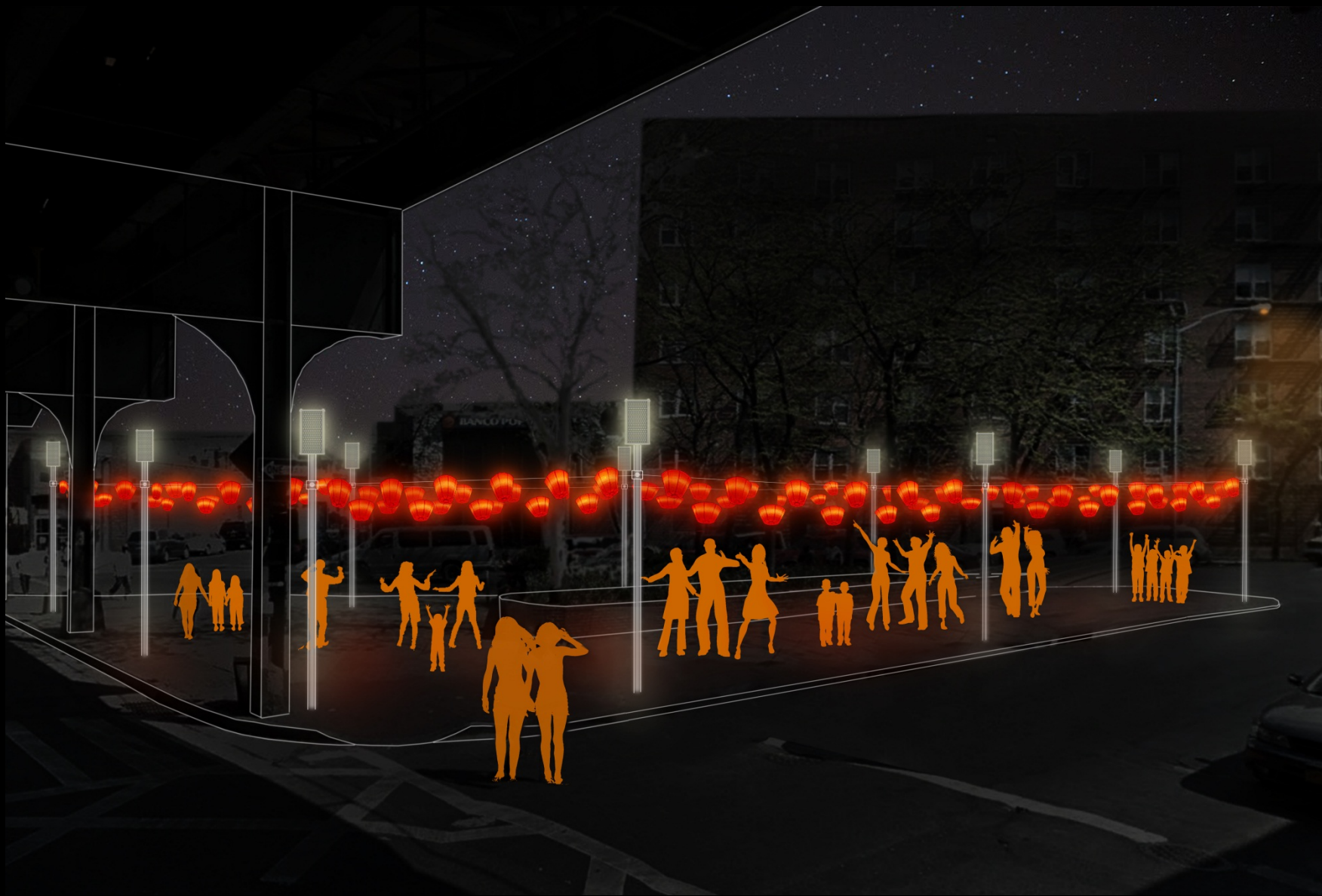

The Queens Lantern Project as part of the Lighting Strategy for 62nd Street and Roosevelt Avenue in Jackson Heights, Elmhurst, and Corona
 Living Lanterns: Activating Community Public Space with a Festival of Light.

Keyplan

Applies to:
 Dunningham Triangle
 Manuel De Dios Ustruue Triangle
 Elmhurst Avenue Square
 Adia Street - Whitway Avenue Square
 37th Avenue - Roosevelt Avenue Square
 Spruce Street - 62nd St. Square
 103rd Street - Corona Plaza

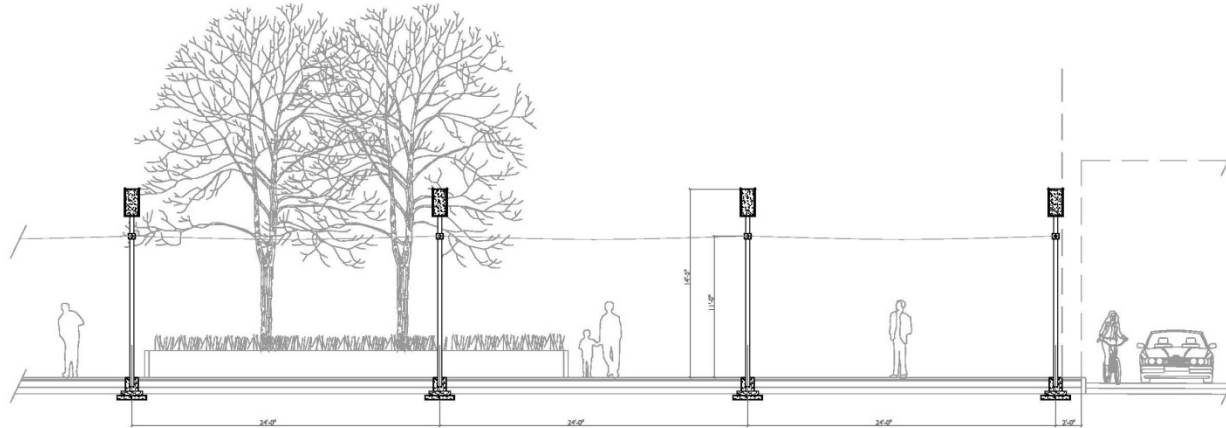
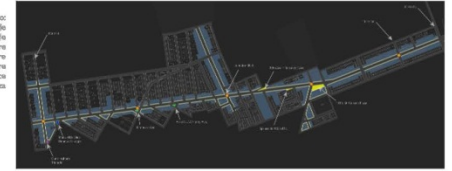

Inspiration: Lantern Festival
 Scale: N/A

Scale Study Section for Manuel De Dios Ustruue Triangle
 Scale: 1/8" = 1'-0"

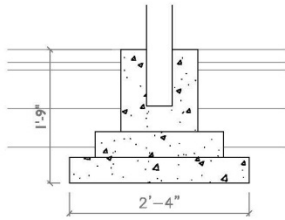

Foundation Pole In-Ground Mounted
 Scale: 3/4" = 1'-0"



Detail Pole Diameter
 Scale: 3/4" = 1'-0"

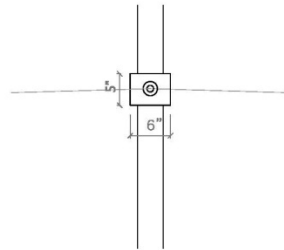

Detail Cable Mounting
 Scale: 3/4" = 1'-0"

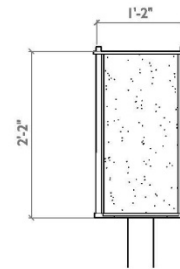

Detail Shielded Light Top
 Scale: 3/4" = 1'-0"



Pole Lantern
 Scale: N/A



Material Reference - Sparkle Textured Glass
 Scale: N/A

LIGHT PROJECTS™
 LENI SCHWENDINGER
 44 East 32nd St, Third Floor
 New York, NY 10016
 www.lgprojectsltd.com
 tel 212.947.6282
 fax 212.947.6289

385 - Lighting Strategy - A Roadmap for Illumination
 Title: Living Lanterns
 Scale: As noted on - Print on Tabloid
 Date: November, 2013 - Issue for Presentation

82SP - 01 - LANTERN

The Queens Lantern Project as part of the Lighting Strategy for 82nd Street and Roosevelt Avenue in Jackson Heights, Elmhurst, and Corona
 One Light at Night: A Storefront Program

Applies to:
 All storefronts supporting the BID

Keyplan

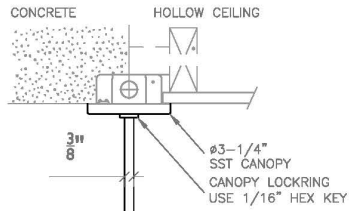
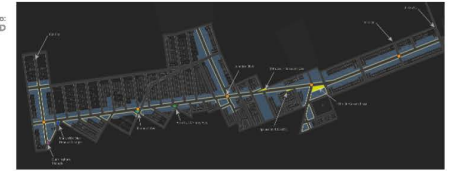

Detail Mounting
 Scale: 3" = 1'-0"

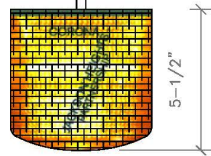

Detail Beacon Light - Side View

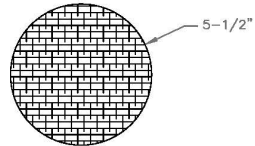

Detail Beacon Light - Bottom View
 Scale: 3" = 1'-0"



Detail BID-Support Light
 Scale: 3/4" = 1'-0"



7-Line Solar Beacon Pendant
 Scale: N/A



Inspiration NYCTA Beacon Lemans
 Scale: N/A



Solar Panel Options
 Scale: N/A



Material Reference - Prismatic Glass
 Scale: N/A

LIGHT PROJECTSTM
 LENI SCHWENDINGER PROJECTS
 44 East 32nd St, Third Floor
 New York, NY 10016
 www.lightprojects.com
 tel 212.947.6282
 fax 212.947.6289

385 - Lighting Strategy - A Roadmap for Illumination
 Title: One Light at Night
 Scale: As noted on - Print on Tabloid
 Date: November, 2013 - Issue for Presentation

82SP - 02 - ONE LIGHT





Underpass Light - Illuminating the Corridor & Extending Place

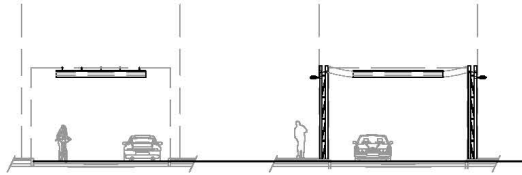

Mounting Option 1 - Attached to MTA structure
Scale: 1/16" = 1'-0"

Mounting Option 2 - Attached to additional poles
Scale: 1/16" = 1'-0"



Detail 82nd Street Subway Station Underpass Light

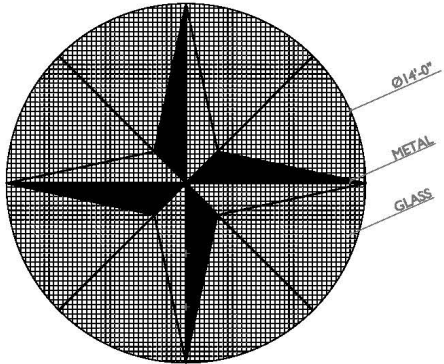

Detail 82nd Street Subway Station Underpass Light - Window Bottom View
Scale: 1/4" = 1'-0"

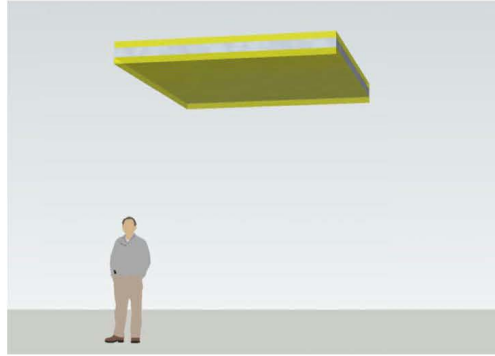

Egress Diamond Subway Station Underpass Light
Scale: N/A

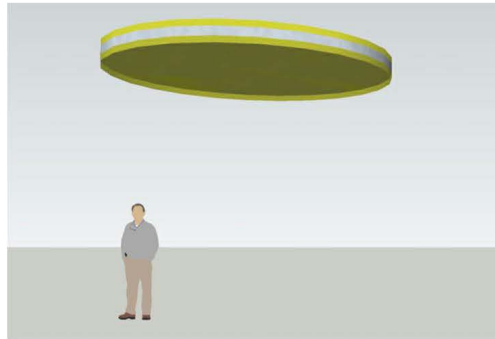

Local Round Subway Station Underpass Light
Scale: N/A

Applies to:
82nd Street - Jackson Heights (Local)
90th Street - Elmhurst Avenue (Local)
Junction Boulevard (Egress)
168rd Street - Corona Plaza (Local)
111th Street (Local)

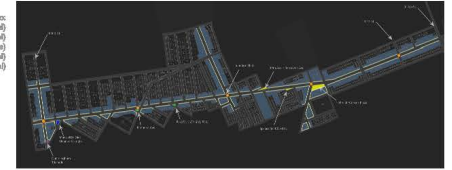

Keyplan

7 Line along Roosevelt Avenue 'Local' or 'Egress' defines the shape

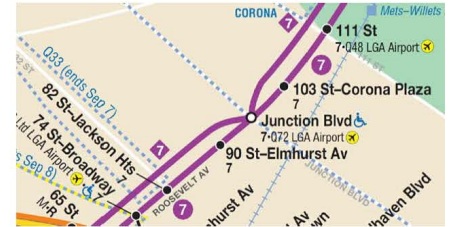

7 Line along Roosevelt Avenue 'Local' or 'Egress' defines the shape
Scale: N/A



Inspiration Signage and Light Disk
Scale: N/A



LED Technology - Ocean BoxLED
Scale: N/A

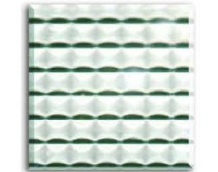

Material Reference - Cross Prismatic Glass
Scale: N/A

Jackson Heights, Corona Partnership Lighting Strategy

A Roadmap for Illumination, Placemaking and Community-Building
Queens, New York City
2014



Content

Brief

The Project

Methodology

Summary

Working together

Lighting Principles

Design Proposals

Living Lanterns – A Festival of Light

One Light at Night – A Storefront Project

Underpass Light - Illuminating the Corridor & Enhancing Place

Appendix

Problem Areas

Light Reading Analysis

NightSeeing

Community Workshop

 NightSeeing comes to
Queens, July 2013

- Guidelines, proposals, recommendations